

SECTION #1

TM 9-2330-207-24P

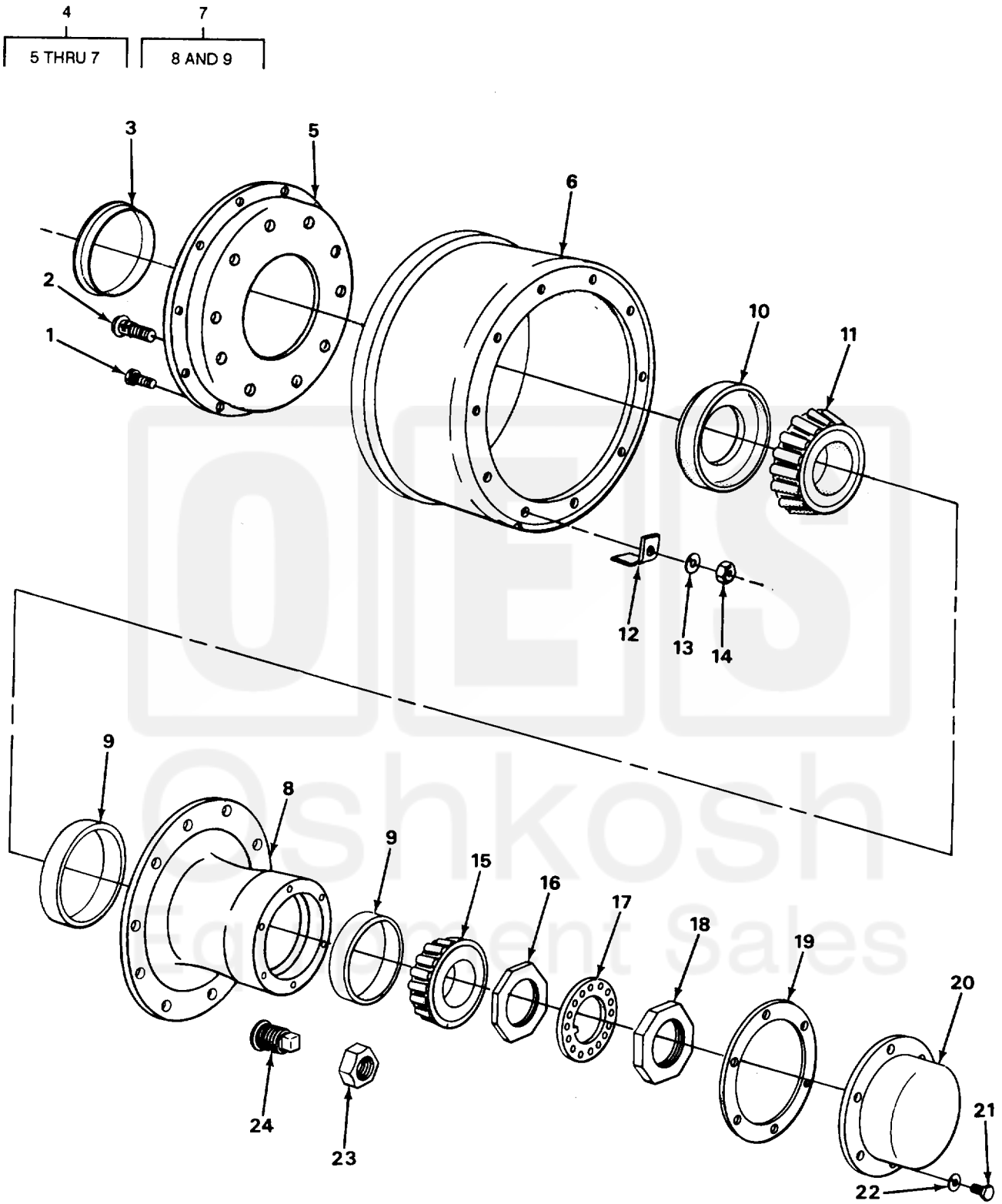

TA706121

FIGURE 39. HUB AND BRAKEDRUM ASSEMBLY (ALL EXCEPT M127).

Current part is item (9) on diagram. Available at [www.oshkoshequipment.com](http://www.oshkoshequipment.com)

| SECTION<br>(1)<br>ITEM<br>NO                            | II<br>(2)<br>SMR<br>CODE | (3)<br>CAGEC | TM9-2330-207-24P<br>(4)<br>PART<br>NUMBER | (5)<br>DESCRIPTION AND USABLE ON CODES (UOC)                                      | (6)<br>QTY |
|---|--------------------------|--------------|---|---|------------|
| GROUP 1311 WHEEL ASSEMBLY                               |                          |              |   |   |            |
| FIG. 39 HUB AND BRAKEDRUM ASSEMBLY<br>(ALL EXCEPT M127) |                          |              |   |   |            |
| 1   | PAOZZ                    | 19207        | 7979179                                   | BOLT,RIBBED SHOULDE<br>UOC:131,133,671,673,674,680,681,682,<br>684                | 20         |
| 2   | PAOZZ                    | 96906        | MS51946-1                                 | BOLT,RIBBED SHOULDE LH<br>UOC:131,133,671,673,674,680,681,682,<br>684             | 10         |
| 2   | PAOZZ                    | 96906        | MS51946-2                                 | BOLT,RIBBED SHOULDE RH<br>UOC:131,133,671,673,674,680,681,682,<br>684             | 10         |
| 3   | PAOZZ                    | 19207        | 7409553                                   | RING,WIPER<br>UOC:131,133,671,673,674,680,681,682,<br>684                         | 2          |
| 4   | AOOOO                    | 19207        | 8710721                                   | HUB,WHEEL,VEHICULAR LEFT HAND<br>UOC:131,133,671,673,674,680,681,682,<br>684      | 1          |
| 4   | XBOZZ                    | 19207        | 8710722                                   | HUB AND DRUM RIGHT HAND<br>UOC:131,133,671,673,674,680,681,682,<br>684            | 1          |
| 5   | PAOZZ                    | 19207        | 8710724                                   | .ADAPTER,BRAKE DRUM LEFT AND RIGHT<br>UOC:131,133,671,673,674,680,681,682,<br>684 | 1          |
| 6   | PAOZZ                    | 19207        | 7409394                                   | .BRAKE DRUM<br>VOC:131,133,671,673,674,680,681,682,<br>684                        | 1          |
| 7   | XB0ZZ                    | 09389        | 71936E                                    | HUB ASSEMBLY<br>UOC:131,133,671,673,674,680,681,682,<br>684                       | 4          |
| 8   | XB0ZZ                    | 19207        | 8710723                                   | .HUB,TRAILER WHEEL<br>UOC:131,133,671,673,674,680,681,682,<br>684                 | 1          |
| 9   | PAOZZ                    | 21450        | 706691                                    | .CUP,TAPERED ROLLER<br>UOC:131,133,671,673,674,680,681,682,<br>684                | 1          |
| 10  | PAOZZ                    | 19207        | 7979349                                   | SEAL,PLAIN ENCASED<br>UOC:131,133,671,673,674,680,681,682,<br>684                 | 2          |
| 11  | PAOZZ                    | 96906        | MS19081-137                               | BEARING,ROLLER,TAPE INNER<br>UOC:131,133,671,673,674,680,684                      | 2          |
| 12  | PAOZZ                    | 19207        | 7979315                                   | COVER,ACCESS<br>UOC:131,133,671,673,674,680,681,682,<br>684                       | 1          |
| 13  | PAOZZ                    | 96906        | MS35338-47                                | WASHER,LOCK<br>UOC:131,133,671,673,674,680,681,682,<br>684                        | 20         |
| 14  | PAOZZ                    | 96906        | MS51968-11                                | NUT,PLAIN,HEXAGON<br>UOC:131,133,671,673,674,680,681,682,<br>684                  | 20         |

Current part is item (9) on diagram. Available at [www.oshkoshequipment.com](http://www.oshkoshequipment.com)